

**BlackBerry Radar R2 Visor Retrofit Instructions—Rev 3**

**Purpose:** This document provides instructions on how to install the Radar R2 Visor Accessory on a previously installed Radar R2 Module. The Radar R2 Visor is designed to improve Cargo Percentage detection on Barn Door Trailers, where the Radar R2 module is installed on the side wall at 90" (229cm) above the trailer floor.

**Parts Required to Complete the Installation (Included):**

Item	Part Number	Part Description	QTY
1	HDW-63754-001	R2 Visor Accessory	1
2	FAS-63756-001	R2 Visor Screw	1

**Parts Required to Complete the Installation (Not Included)**

Item	Part Number	Part Description	QTY
3	XXX-XXXXX-XXX	Radar R2 Module and 20° Bracket Assembly	1
4	XXX-XXXXX-XXX	Screwdriver or Cordless Drill with Bit (tool choice dependent on fasteners used to mount the Radar R2 Module to the asset)	1
5	XXX-XXXXX-XXX	7/16" Nut Driver/Socket/ Wrench (Use to remove lock nuts from 20° Tilt Bracket.)	1
6	XXX-XXXXX-XXX	3/8" Nut Driver/Socket/ Wrench (Use to remove bolts from 20° Tilt Bracket.)	1

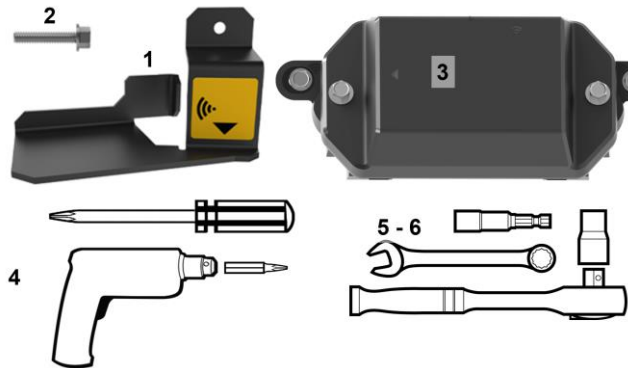
**Installation Instructions:**

1. Remove the fasteners that attach the Radar R2 module to the asset. Remove the Radar R2 Module from the asset.

**NOTE:** The tools used to remove your previously installed Radar R2 module from your asset may vary due to the fastener that were chosen to attach the module to the asset.

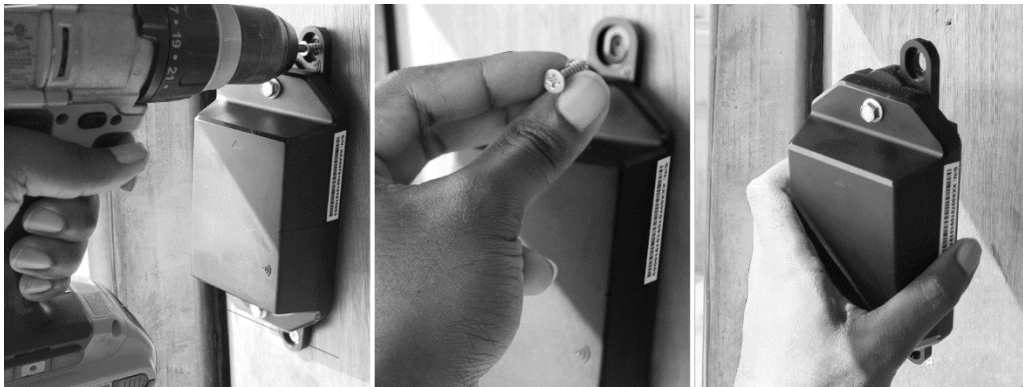

2. Locate the BlackBerry Radar R2 Visor Accessory and Visor Fastener (FAS-63756-001). Install the visor according to the following procedure.



3. On the end of the Radar R2 module, nearest to the Signal Icon, remove the fastener that attaches the 20° Side Mount Bracket to the Radar R2 module. Save the locknut, as you will apply this locknut to the R2 Visor Screw to attach the Radar R2 Visor Accessory to the Radar R2 module.

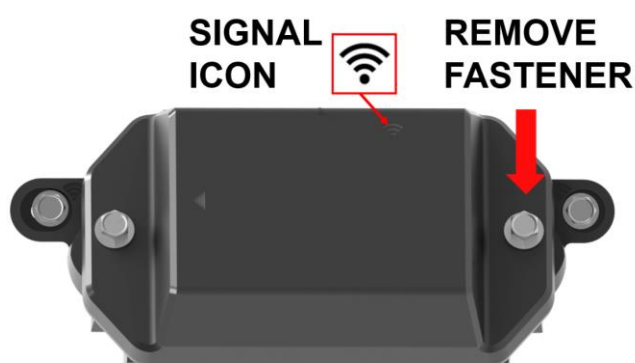

(Continued on Next Page)

4. Remove the liner from the rear of the visor to expose the adhesive.

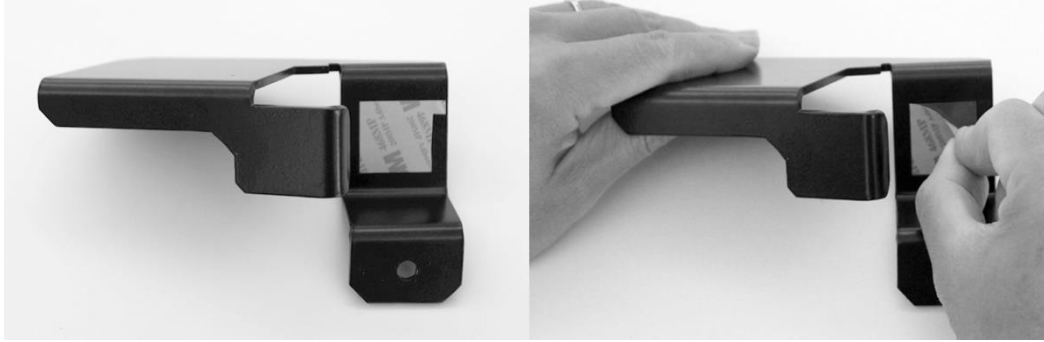

5. Align the orientation of the arrow and signal icon on the visor with the arrow and signal icon on the Radar R2 module. Place the visor onto the device, ensuring the hole on the visor is aligned with the hole on the device. Press the center of the label to activate the adhesive.

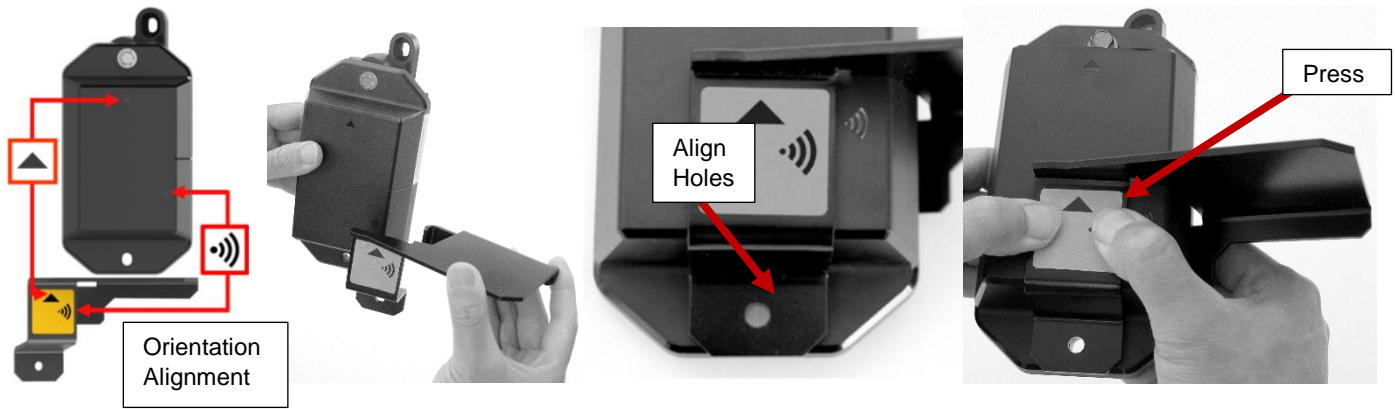

6. Re-install the bracket that was removed in Step 3 to the rear of the Radar R2 module, ensuring the holes on the R2 20° Tilt Bracket are aligned with the holes on the R2 module and visor and the bracket's guide tabs are seated within the rear openings of the module.

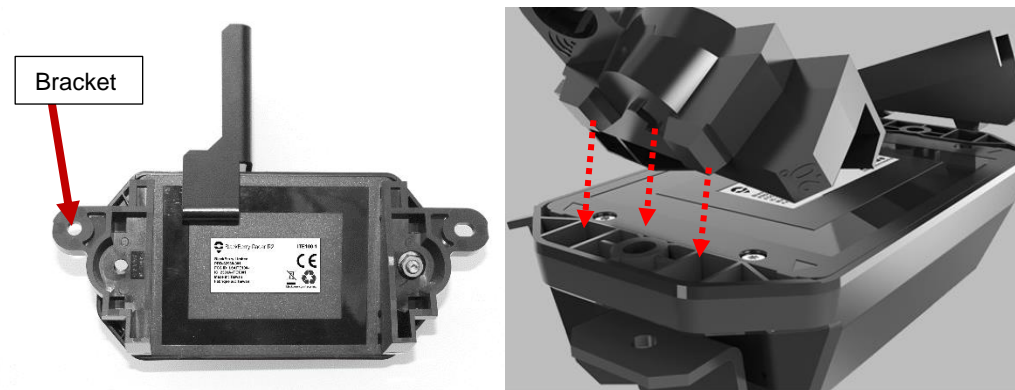

7. Secure the bracket and visor to the R2 module. Do not tighten fastener beyond 35 in-lb. (4 N-m).

**IMPORTANT:** The longer “visor” screw (FAS-63756-001) must be used on the end of the module where the visor is installed. Reuse the locknut removed in Step 3 to secure the visor screw. **NOTE:** One extra screw (from the 20° Bracket) will remain, post-installation.



8. Re-install R2 module and visor assembly to the asset, using the tools and fasteners of your choice.

**IMPORTANT:** When installing the R2 module and visor assembly to the asset, ensure the arrow icon points upward and signal icon points towards the cargo area.

